

ORBI-3™ Masters Limited Access Tank Cleaning Challenges

The Sellers® Orbi-3™ Rotating Tank Cleaner provides complete interior tank cleaning that is both thorough and cost-effective. The unit offers simplicity of design and economic value for use in a wide variety of industries including:

- Chemical Processing
- Dairy
- Pharmaceuticals
- Beverage
- Food Processing
- Many Others

5 Models Now Available

Ideal for Portable and CIP Applications

The Orbi-3 is specifically designed to fit a 3 in (76.2 mm) opening, making it ideal for use with IBC's, totes, or other limited access vessels, and small tanks up to 20 feet (6.1 m) in diameter. The rotating head, driven by the hydraulic pressure of the cleaning solution, produces dual streams that contact all surface areas. In addition, the Orbi-3 needs no lubrication, eliminating potential contamination. Optional sanitary fittings and lower pressure models available.

Optimum Cleaning Action

The dual nozzle, rotating head of the Orbi-3 concentrates hot or cold cleaning solutions into an efficient cleaning stream that provides a thorough 360 degree cleaning pattern. The Orbi-3 rotates on two axes and can be used with many types of fluids, sanitizers, detergents, solvents, and caustics.



Specifications

| | | | |
|-------------------------------|---------------------------|----------------------------|---------------------------------|
| * Operating Pressure: | 50-300 PSI (3.5-20.7 BAR) | Nozzle Orifice Diameter: | .125 (3.2 mm)-.234 in. (5.9 mm) |
| Flow Capacity: | 12-25 GPM (42-102 l/m) | Pipe Connection: | 3/4 in. Female NPSC |
| Max. Operating Temp: | 250°F (121°C) | Approx. Weight: | 1 3/4 lbs (0.8 kgs) |
| Tank Opening Size: | 3 in. (76.2 mm) | Materials of Construction: | 316 Stainless Steel |
| ** Effective Cleaning Radius: | 10 ft (3.1 m) | | Food Grade Plastics |
| Effective Wetting Radius: | 15 ft (4.6 m) | *** Recommended Solution | |
| Overall Head Length: | 6 1/4 in. (159 mm) | Strainer: | 20 Mesh (1/32 in openings) |
| Number of Nozzles: | 2 | | |

* Models also available for pressure ranges below 50 PSI (3.5 BAR)

** Depends upon type and condition of soils removed.

*** Required for most applications to prevent fouling or plugging of unit from foreign material, i.e., scale, grit and soils in solution. Additional strainers and/or finer mesh screens may be required depending upon amount, nature and size of foreign materials in solution.

Orbi-3 Performance Curves

Designed for Economic Performance

The Orbi-3 is designed to provide economical performance. It is made of the finest materials, including stainless steel and food grade plastics, to provide reliable service. It contains no gears or seals to wear out and requires no external power source or add-on equipment to maintain. The simplicity of design uses fewer parts and reduces your maintenance costs.

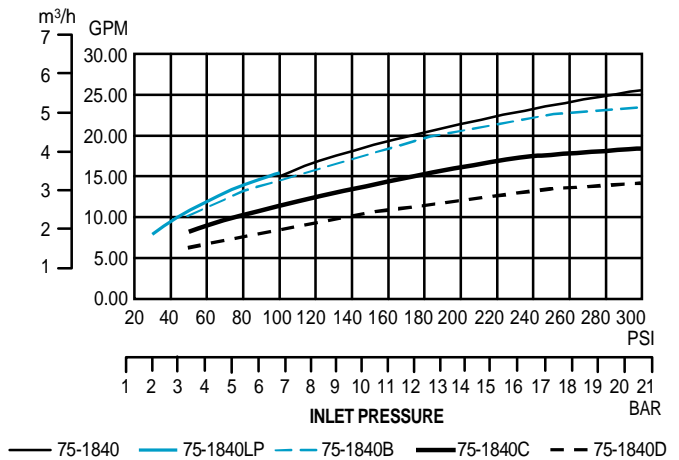

Parts List

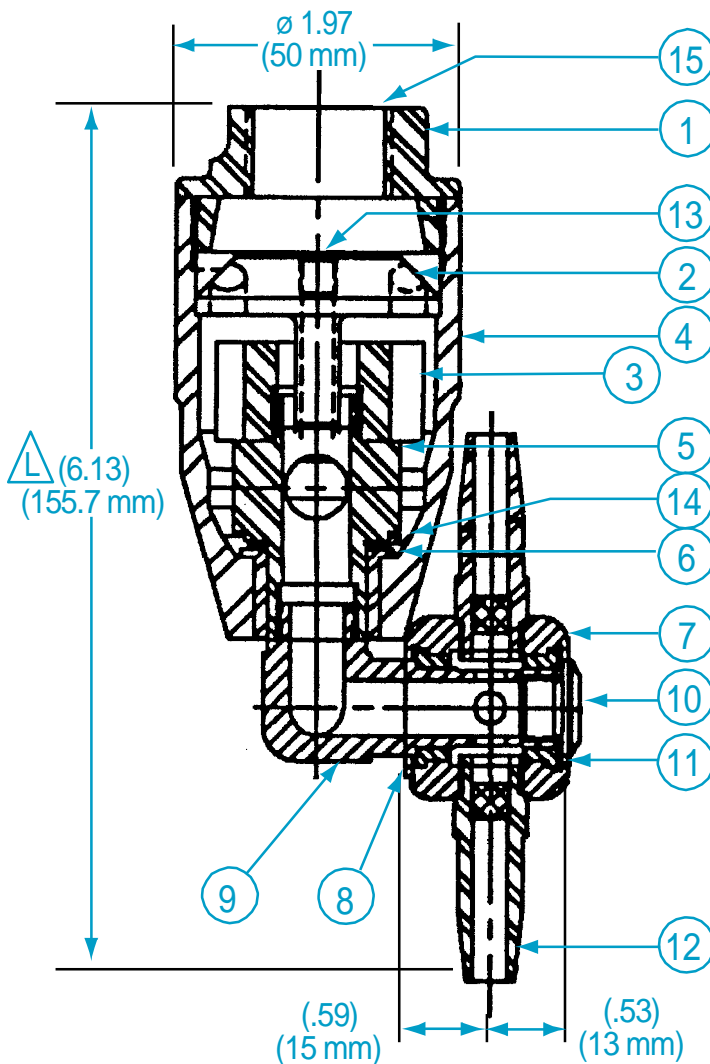

| Item No. | Part or Identifying No. | Description |
|----------|-------------------------|------------------------------------|
| 1 | 75-1403 | Cap, Inlet |
| 2 | 75-1850 | Motor, Water |
| 3 | 75-1801SS | Rotor, 6 Tooth |
| 4 | 75-1467 | Body, Main |
| 5 | 75-1841 | Shaft, Vertical |
| 6 | 75-1408 | Bushing |
| 7 | 75-1845 | Body, Nozzle |
| 8 | 75-1846 | Bushing |
| 9 | 75-1842 | Shaft, Elbow |
| 10 | 75-1844 | Cap, Shaft |
| 11 | 75-1847 | Ring, Retaining |
| 12 | 75-1849AA | Nozzle Assembly, $\varnothing.234$ |
| 13 | | Plug, Bypass, as required |
| 14 | 75-1416 | Washer, Vertical Shaft |
| 15 | | Protective Cap |
| 16 | 625-03561 | Never Seez |
| 17 | 75-1840-SPK | Kit, Parts, Spare |
| 17-1 | 75-1416 | Washer, Vertical Shaft |
| 17-2 | 75-1847 | Ring, Retaining |
| 17-3 | 75-1846 | Bushing |
| 17-4 | 75-1408 | Bushing |
| 17-5 | 7-33-1 | Plug, Bypass, Solid |

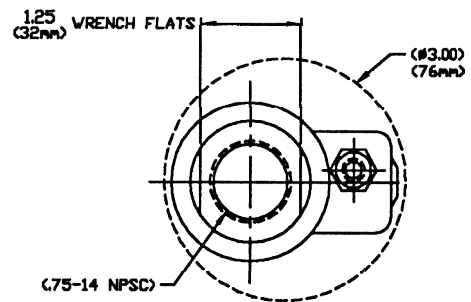

ORBI-G3 Limited Access Tank Cleaner

The Sellers[®] Orbi-G3 Rotating Tank Cleaner provides complete tank cleaning that is both thorough and cost-effective. This NEW model offers the same features found in most SELLERS products:

- Fluid drive with external gears.
 - The Orbi-G3 is specifically designed to fit a 3 in. opening, and this model incorporates a set of bevel gears which provide a complete 360 degree indexing pattern, every 45 revolutions, making it ideal for use with IBC's, totes, or other limited access vessels, and small tanks up to 30 feet in diameter.
- The rotating head, driven by the hydraulic pressure of the cleaning solution, produces dual streams that contact all surface areas. The Orbi-G3 needs no lubrication, and provides the impact needed for the most difficult cleaning applications.
- Simplicity of design and economic value for use in a wide variety of industries:
 - BULK TRANSPORT
 - BEVERAGE
 - CHEMICAL PROCESSING
 - FOOD PROCESSING
 - PHARMACEUTICAL
 - DAIRY
 - AND MANY OTHERS

**Designed for Optimum
Cleaning Action and
Economic Performance**

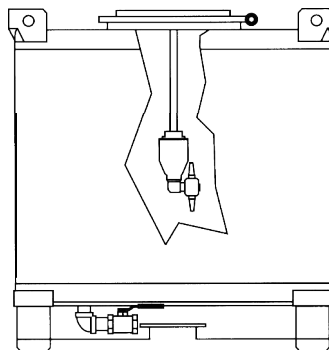

Specifications

| | | | |
|----------------------------|---------------------------|----------------------------------|---------------------|
| Operating Pressure: | 75-300 PSI (5.2-20.7 BAR) | Nozzle Orifice Diameter Options: | .234 in. (5.9 mm) |
| Flow Capacity (4 models): | 11-27 GPM (42-102 l/m) | | .172 in. (4.4 mm) |
| Max. Operating Temp: | 250°F (121°C) | Approx. Weight: | 2 lbs (0.9 kgs) |
| Tank Opening Size: | 3 in. (76.2 mm) | Materials: | 316 Stainless Steel |
| Effective Cleaning Radius: | 15 ft (4.6 m) | | Food Grade Plastics |
| Pipe Connection: | 3/4 in. Female NPSC | Overall Head Length: | 6-1/4 in. (159 mm) |
| | | No. of Nozzles: | 2 |

Orbi-G3 Performance Curves

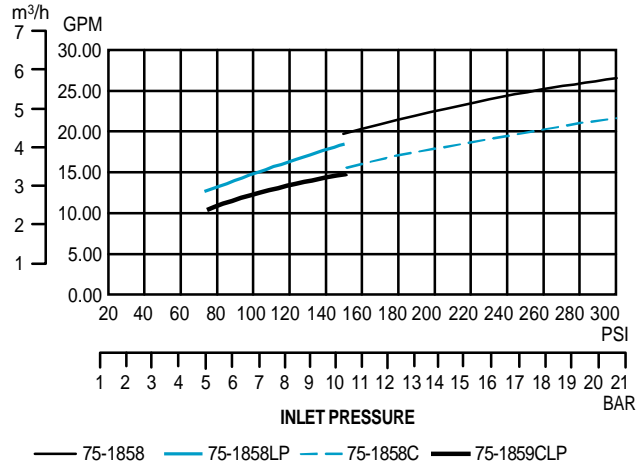

Parts List

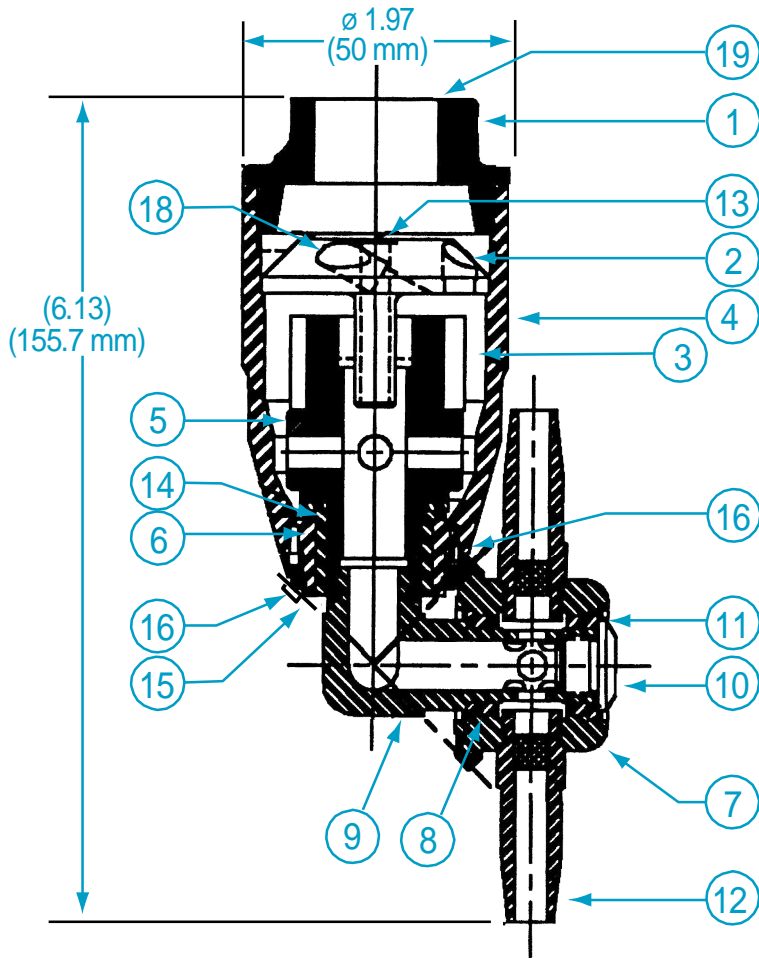

| Item No. | Part or Identifying No. | Description |
|----------|-------------------------|------------------------------------|
| 1 | 75-1403 | Cap, Inlet, 1.97 x 1 |
| 2 | 75-1857 | Motor, Water, 4 hole, 1.69 OD |
| 3 | 75-1801SS | Rotor, 6 Tooth |
| 4 | 75-1853 | Body, Main, 1.93 Dia. |
| 5 | 75-1854 | Shaft, Vertical, 1.0 Hex, 1.75 Lg. |
| 6 | 75-1408 | Bushing, Shaft |
| 7 | 75-1851 | Body, Nozzle, Geared, 1.54 OD |
| 8 | 75-1846 | Bushing, Flanged |
| 9 | 75-1859 | Shaft, Elbow |
| 10 | 75-1844 | Cap, Shaft, .66 Dia. x .38 Lg. |
| 11 | 75-1847 | Ring, Retaining |
| 12 | 75-1849AA | Nozzle Assembly, Ø.234 |
| 13 | | Plug, Bypass, as required |
| 14 | 75-1863G | Washer, Shaft |
| 15 | 75-1855 | Ring, Retaining, 1.0 ID |
| 16 | 75-1852 | Gear, Bevel, 1.52 OD |
| 17 | 75-1856 | Pin, Roll, Ø.066 |
| 18 | 75-1455-E | Plug, Bypass, Ø.156 |
| 19 | | Protective Cap |
| 20 | 625-03561 | Never Seez |
| 21 | 75-1858-SPK | Kit, Parts, Spare |
| 21-1 | 75-1856 | Pin, Roll, Ø.066 |
| 21-2 | 75-1863G | Washer, Shaft |
| 21-3 | 75-1847 | Ring, Retaining |
| 21-4 | 75-1846 | Bushing, Flanged |
| 21-5 | 75-1408 | Bushing, Shaft |
| 21-6 | 7-33-1 | Plug, Bypass, Solid |

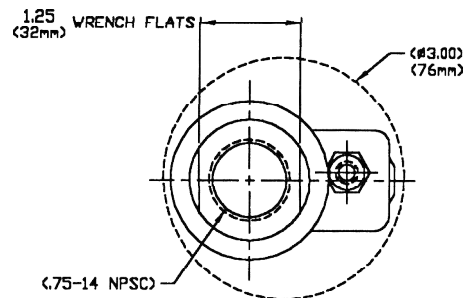

CRANE[®]

A Crane Co. Company

www.tankwasher.com

APPLIED SPRAY TECHNOLOGY
 385 Fairway Rd. S., Suite 4A-225
 Kitchener, Ontario N2C 2N9
 PH: 519-896-2200 FX: 519-896-2201

ORBI-G4 Tank Cleaner

The Sellers[®] Orbi-G4 provides a thorough and cost-effective 360 degree indexing spray pattern, that repeats every 45 revolutions. Designed to fit through a 3.75" opening, the four nozzle Orbi offers high impact cleaning of tanks, or vessels up to 30 feet in diameter.

Ideal for cleaning of totes, IBC's, or processing tanks in most industries. This NEW model provides the same reliable features found in most SELLERS products:

- Self-cleaning flow through design
- Pressures from 50-300 psi, and flows from 8-33 gpm
- Effective cleaning radius up to 15 feet
- 3 different nozzle sizes (.172", .140", .125")
- Ease of field maintenance
- May install on a permanent basis (CIP) or use in a portable manner

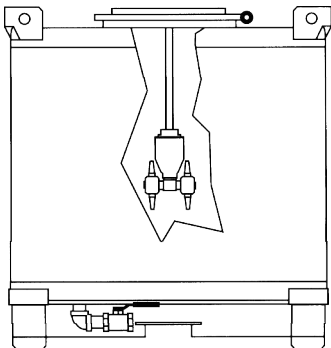

Specifications

| | | | |
|----------------------------|---------------------------|--------------------------|---------------------------------------|
| Operating Pressure: | 50-300 PSI (3.4-20.7 BAR) | Nozzle Orifice Diameter: | .125 in. (3.2 mm)-.172 in. (4.4 mm) |
| Flow Capacity: | 8-33 GPM (30-125 l/m) | Approx. Weight: | 3 lbs (0.9 kgs) |
| Max. Operating Temp: | 250°F (121°C) | Materials: | 316 Stainless Steel, Teflon & UHMW-PE |
| Tank Opening Size: | 3.75 in. (95.2 mm) | | |
| Effective Cleaning Radius: | 15 ft (4.6 m) | Overall Head Length: | 6-1/4 in. (159 mm) |
| Pipe Connection: | 3/4 in. Female NPSC | No. of Nozzles: | 4 |
| Head Rotation Speed: | 7-17 RPM | | |

Orbi-G4 Performance Curves

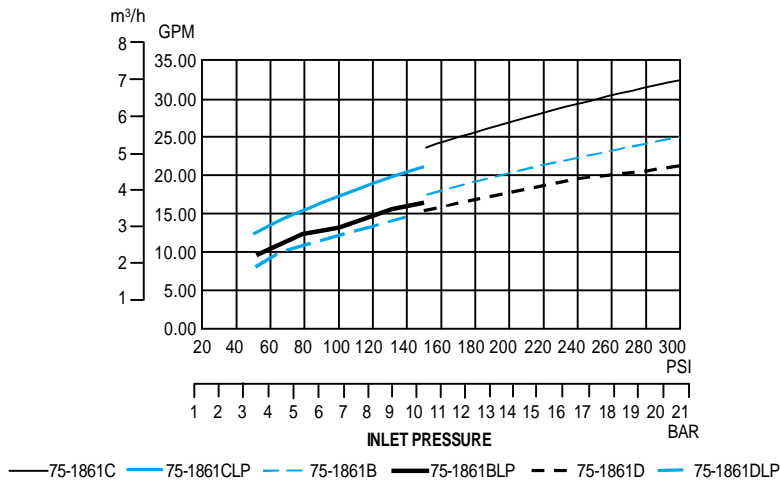

Parts List

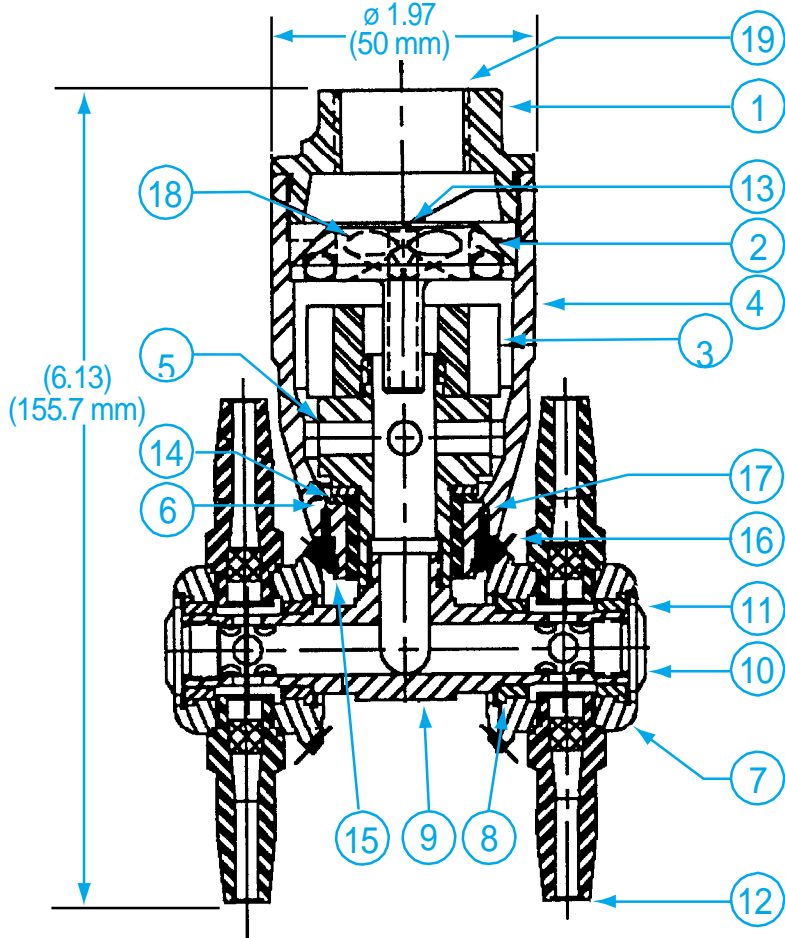

| Item No. | Part or Identifying No. | Description |
|----------|-------------------------|--------------------------------|
| 1 | 75-1403 | Cap, Inlet |
| 2 | 75-1857 | Motor, Water, 4 hole |
| 3 | 75-1801SS | Rotor, 6 Tooth |
| 4 | 75-1853 | Body, Main |
| 5 | 75-1854 | Shaft, Vertical |
| 6 | 75-1862 | Bushing, Shaft |
| 7 | 75-1851 | Body, Nozzle, Geared |
| 8 | 75-1846 | Bushing |
| 9 | 75-1860 | Shaft, Elbow |
| 10 | 75-1844 | Cap, Shaft |
| 11 | 75-1847 | Ring, Retaining |
| 12 | 75-1849CA | Nozzle Assembly, Ø.172 |
| 13 | | Plug, Bypass, size as required |
| 14 | 75-1863G | Washer |
| 15 | 75-1855 | Ring, Retaining |
| 16 | 75-1852 | Gear, Bevel |
| 17 | 75-1856 | Pin, Roll, Ø.062 |
| 18 | 75-1455-D | Plug, Bypass, Ø.156 |
| 19 | | Protective Cap |
| 20 | 625-03561 | Never Seez |
| 21 | 75-1861-SPK | Kit, Parts, Spare |
| 21-1 | 75-1856 | Pin, Roll, Ø.062 |
| 21-2 | 75-1863G | Washer |
| 21-3 | 75-1847 | Ring, Retaining |
| 21-4 | 75-1846 | Bushing |
| 21-5 | 75-1862 | Bushing, Shaft |
| 21-6 | 7-33-1 | Plug, Bypass, Solid |

